

MB014SP-B R1



Scan the QR code for more product information

Copyright © ICY DOCK International. All Rights Reserved. 650314 VER 1.0



Cremax Europe GmbH  
Email: support@icydock.com  
Weidenweg 21H, 47059 Duisburg, Germany



Beyond Technologies UK Ltd  
Email: info@beyondtech.co.uk  
Unit B6, Halesfield 11, Telford, Shropshire, TF7 4PH, U.K.

### 1

Package Contents • Packungsinhalt • Contenu • Contenido del paquete • 包装について • 包装説明 • 包装说明



Device



User Manual



10 x M3\*2.5 Screws for Device  
(2 x screws for spare parts)

Note: Please use the included screws to secure the drive(s).

### 2

Device Information • Geräteinformationen • Informations dispositif • Información del dispositivo • 本体説明 • 機體説明 • 机体说明

#### ▼ Front View

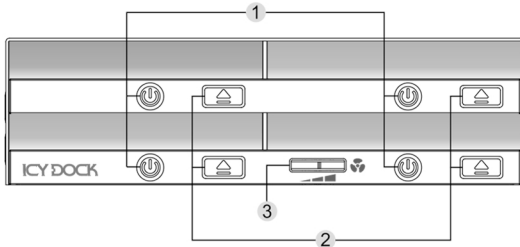

- 1 Drive Power Buttons / LED Indicator  
-Device Power : Solid Blue Light  
-HDD Access : Flashing Blue Light
- 2 Drive Ejection Buttons
- 3 Fan Speed Control (The default setting of fan speed is set to maximum)

#### ▼ Rear View

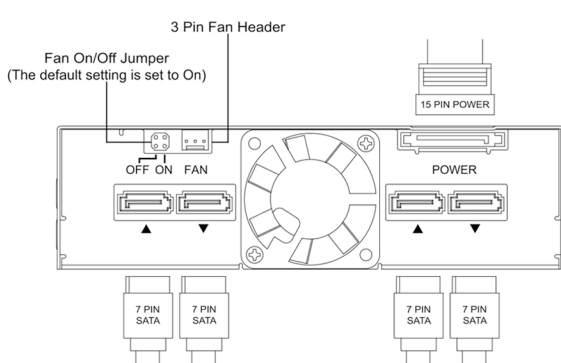

### 3

Installation Guide • Installationsanleitung • Guide d'Installation • Guía de instalación • 製品の組み込み手順について • 操作手順 • 操作步驟

3-1. Installing 2.5" Drives - Insert the drive all the way into the slot.

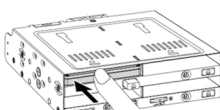
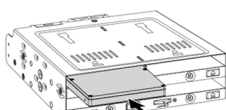

3-2. Powering on the Drives - Push the drive power buttons inward to power up the drive.

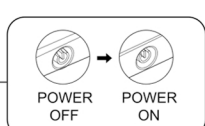
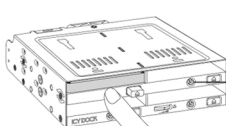

3-3. Removing 2.5" Drives - Push the drive eject button to eject the drive from the slot. Once the drive is ejected, simply pull on the drive to remove.

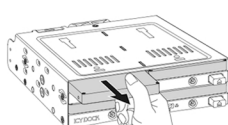
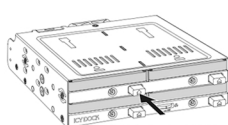

# ICY DOCK®

www.icydock.com

